

Scraper Conveyor Series Product Catalogue



 **三一重装国际控股有限公司**
SANYHE INTERNATIONAL HOLDINGS CO.,LTD
Address: No. 25, No. 16 Street, Kaifa Avenue, Economic and Technical
Development Zone, Shenyang, Liaoning, China
Postal code: 110027 Customer service hotline: 4008-808-318
Website: www.sanyhe.com
This brochure is for reference only and is subject to changes without further
notice and the contract or real product shall prevail for all configurations.



Update date: October, 2017

Due to continuous update of technologies, the technical specification is subject to changes without further notice. The machine shown in the diagram probably contains additional equipment. The copyright is reserved by Sany Heavy Equipment Co., Ltd. Without the written consent of Sany Heavy Equipment Co., Ltd., it's prohibited to copy or duplicate any part of this brochure for any purpose.

www.sanyhe.com

www.sanyhe.com



Introduction of scraper conveyor series product

Inheriting the high quality characteristic of Sany products, Sany scraper conveyor features no vibration, no broken chain, super durability, high reliability, soft start, and self-diagnosis, with the coal flow-through capacity far beyond the industry's level. Sany Heavy Equipment Co., Ltd. is presently the sole enterprise supplying coal mining machine, support, and scraper conveyor in the industry and its highly integrated, modularized, and automated products can realize the unmanned and intelligent production with less manpower in the fully mechanized coal mining face.



Product Lineup



Scraper conveyor



- SGZ630 series scraper conveyor
- SGZ764 series scraper conveyor
- SGZ800 series scraper conveyor
- SGZ900 series scraper conveyor
- SGZ1000 series scraper conveyor

Elevating conveyor

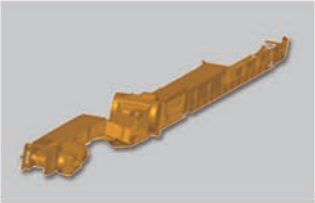

- SZZ764 series elevating conveyor
- SZZ800 series elevating conveyor
- SZZ900 series elevating conveyor
- SZZ1000 series elevating conveyor
- SZZ1200 series elevating conveyor

Crushing machine



- PLM1000 crushing machine
- PLM1800 crushing machine
- PLM2000 crushing machine
- PLM2500 crushing machine
- PLM3500 crushing machine
- PLM4000 crushing machine



PRODUCT ADVANTAGES AND FEATURES



Product features of SGZ630 series

- 1. Applicable for the working faces in yearly production capacity of 300,000~600,000t.
- 2. Capable of supporting two types of coal mining machines (Cross-ledge type and cross-scraper type).
- 3. Applicable for fully mechanized mining and high-end general mining faces.
- 4. The medium plate is installed with SYN400 to achieve higher wear resistance.



Product features of SGZ764 thin seam series

- 1. For supporting the operations of our 400B thin seam coal mining machine.
- 2. The lower horizontal headstock and tailstock with horizontal or low inclination ramp chute ease the supporting of low seam operations.
- 3. Cast and welded end-sealing middle chute with ledge height at 255mm.
- 4. The medium plate is installed with SYN400 to achieve higher wear resistance.



Product features of SGZ2764 series

- 1. Applicable for the working faces in yearly production capacity of 600,000~1,000,000t.
- 2. Design optimized drive device for higher reliability.
- 3. Cast and welded end-sealing middle chute with ledge height at 290mm.
- 4. The medium plate is installed with SYN400 to achieve higher wear resistance.



Product features of SGZ800 series

- 1. Applicable for the working faces in yearly production capacity of 1,500,000~2,000,000t.
- 2. Design optimized drive device for higher reliability.
- 3. Design optimized tooth profile of sprockets for more uniform wear of tooth faces.
- 4. The medium plate is installed with SYN400 to achieve higher wear resistance.



Product features of SGZ900 series

- 1. Applicable for the working faces in yearly production capacity of 2,000,000~3,000,000t.
- 2. Optional end-unloading or crossed side-unloading headstock.
- 3. Installed 38×137 compact chain features higher reliability.
- 4. The medium plate is installed with SYN400 to achieve higher wear resistance.



Product features of SGZ1000 series

- 1. Applicable for the working faces in yearly production capacity of 3,000,000~4,000,000t.
- 2. Installed variable frequency soft start and intelligent monitoring system.
- 3. Special optimized tooth profile and material with >12mm wear-resistant layer.
- 4. The medium plate is installed with SYN450 to achieve higher wear resistance.



Technical Specification



SGZ1000 series scraper conveyor

Technical Specification

Item name	Technical index	
Specification and trademark	SGZ1000/1050	SGZ1000/1710
Delivery capacity	2000t/h	2200t/h
Design length	250–300m	300m
Total installed power	2 × 525kW	2 × 855kW
Supply voltage	3300V	3300V
Supply frequency	50Hz	50Hz
Unloading mode	End unloading/crossed side unloading	End unloading/crossed side unloading
Starter mode	Double-speed motor/single-speed motor + frequency converter (Optional)	Double-speed motor/single-speed motor + frequency converter (Optional)
Type of middle chute	Cast and welded end-sealing type	Cast and welded end-sealing type
Specification of middle chute	1750 × 1000 × 352mm	1750 × 1000 × 352mm
Specification of round link chain	42×146mm compact chain	48×152mm compact chain
Chain tension mode	Hydraulic motor, telescoping tailstock chain tensioner	Hydraulic motor, telescoping tailstock chain tensioner
Monitoring mode	Intelligent monitoring system (Optional)	Intelligent monitoring system (Optional)

Technical Specification

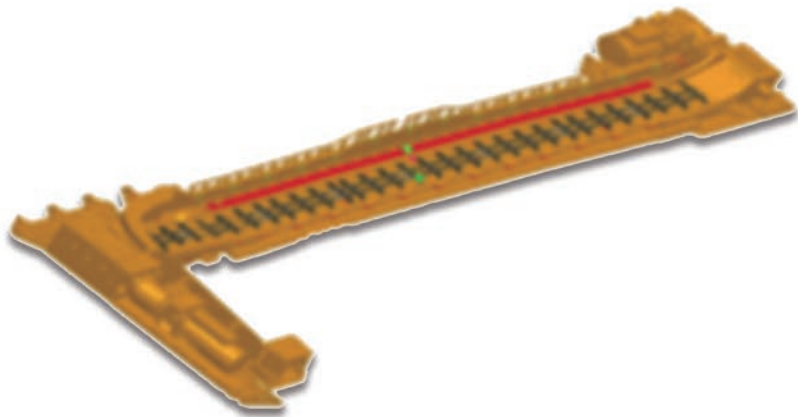

SGZ900 series scraper conveyor

Technical Specification

Item name	Technical index
Specification and trademark	SGZ900/1050
Delivery capacity	1800t/h
Design length	200–250m
Total installed power	2 × 525kW
Supply voltage	3300V
Supply frequency	50Hz
Unloading mode	End unloading/crossed side unloading
Starter mode	Double-speed motor/single-speed motor + frequency converter (Optional)
Type of middle chute	Cast and welded end-sealing type
Specification of middle chute	1500 × 900 × 320mm
Specification of round link chain	38 × 137mm compact chain
Chain tension mode	Hydraulic motor, telescoping tailstock chain tensioner
Monitoring mode	Intelligent monitoring system (Optional)

Technical Specification

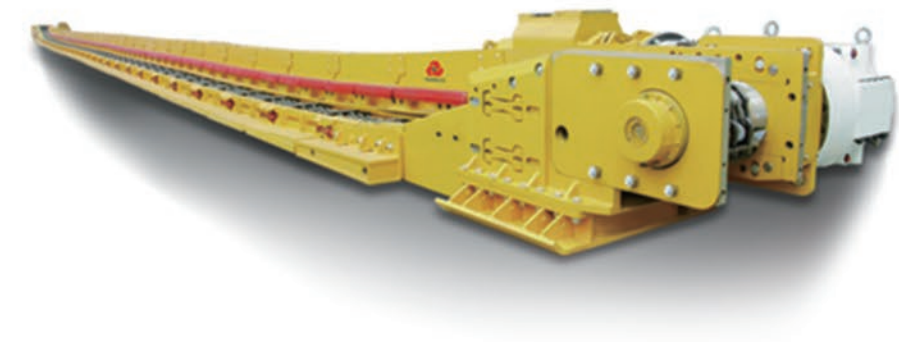

SGZ800 series scraper conveyor

Technical Specification

Item name	Technical index	
Specification and trademark	SGZ800/800	SGZ800/630
Delivery capacity	1500t/h	1500t/h
Design length	250m	250m
Total installed power	2 × 400kW	2 × 315kW
Supply voltage	1140V/3300V	1140V
Supply frequency	50Hz	50Hz
Unloading mode	End unloading	End unloading
Starter mode	Double-speed motor/single-speed motor + soft starter (Optional)	Double-speed motor/single-speed motor + soft starter (Optional)
Type of middle chute	Cast and welded end-sealing type	Cast and welded end-sealing type
Specification of middle chute	1500 × 800 × 303mm	1500 × 800 × 303mm
Specification of round link chain	34 × 126mm	34 × 126mm
Chain tension mode	Hydraulic motor, telescoping tailstock chain tensioner	Hydraulic motor, telescoping tailstock chain tensioner

Technical Specification



SGZ764 series scraper conveyor

Technical Specification

Item name	Technical index
Specification and trademark	SGZ764/630
Delivery capacity	1000t/h
Design length	250m
Total installed power	2 × 315kW
Supply voltage	1140V
Supply frequency	50Hz
Unloading mode	End unloading
Starter mode	Double-speed motor
Type of middle chute	Cast and welded end-sealing type
Specification of middle chute	1500 × 724 × 290mm
Specification of round link chain	30 × 108mm
Chain tension mode	Disc brake chain tensioner/hydraulic motor, telescoping tailstock chain tensioner

Technical Specification



SGZ764/400 scraper conveyor

Technical Specification

Item name	Technical index
Specification and trademark	SGZ764/400
Delivery capacity	800t/h
Design lengt	200m
Total installed power	2 × 200kW
Supply voltage	1140V
Supply frequency	50Hz
Unloading mode	End unloading
Starter mode	Double-speed motor
Type of middle chute	Cast and welded end-sealing type
Specification of middle chute	1500 × 724 × 290 (255) mm
Specification of round link chain	26 × 92mm
Chain tension mode	Disc brake chain tensioner

Technical Specification



SGZ630 series scraper conveyor

Technical Specification

Item name	Technical index	
Specification and trademark	SGZ630/400	SGZ630/264
Delivery capacity	600t/h	450t/h
Design length	200m	200m
Total installed power	2 × 200kW	2 × 132kW
Supply voltage	1140V	1140V
Supply frequency	50Hz	50Hz
Unloading mode	End unloading	End unloading
Starter mode	Double-speed motor	Double-speed motor
Type of middle chute	Cast and welded end-sealing type	Cast and welded end-sealing type
Specification of middle chute	1500 × 590 × 255 (220) mm	1500 × 590 × 255 (220) mm
Specification of round link chain	26 × 92mm (26 × 92 compact chain)	26 × 92mm (26 × 92compact chain)
Chain tension mode	Disc brake chain tensioner	Disc brake chain tensioner